

FACING DIMENSIONS FOR RING JOINTS

ANSI B16.5

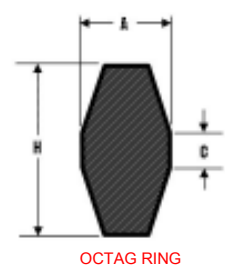
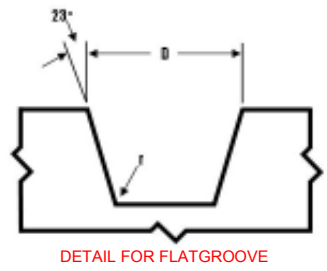
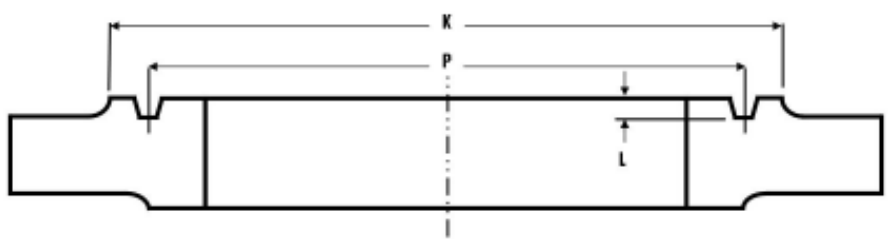

FOR 150 LB.FLANGES								
Nominal Pipe Size	Pitch Dia. Of Ring And Groove P	Dia. Of Raised Face K	Groove		Ring			Approx Distance Between Flanges When Joint is compressed.
			Width D	Depth L	Ring No.	Width A	Height of Oval Ring B	
1	1 7/8	2 1/2	11/32	*1/4	R15	5/16	9/16	5/32
1 1/4	2 1/4	2 7/8	11/32	*1/4	R17	5/16	9/16	5/32
1 1/2	2 9/16	3 1/4	11/32	*1/4	R19	5/16	9/16	5/32
2	3 1/4	4	11/32	1/4	R22	5/16	9/16	5/32
2 1/2	4	4 3/4	11/32	1/4	R25	5/16	9/16	5/32
3	4 1/2	5 1/4	11/32	1/4	R29	5/16	9/16	5/32
3 1/2	5 3/16	6 1/16	11/32	1/4	R33	5/16	9/16	5/32
4	5 7/8	6 3/4	11/32	1/4	R36	5/16	9/16	5/32
5	6 3/4	7 5/8	11/32	1/4	R40	5/16	9/16	5/32
6	7 5/8	8 5/8	11/32	1/4	R43	5/16	9/16	5/32
8	9 3/4	10 3/4	11/32	1/4	R48	5/16	9/16	5/32
10	12	13	11/32	1/4	R52	5/16	9/16	5/32
12	15	16	11/32	1/4	R56	5/16	9/16	5/32
14	15 5/8	16 3/4	11/32	1/4	R59	5/16	9/16	1/8
16	17 7/8	19	11/32	1/4	R64	5/16	9/16	1/8
18	20 3/8	21 1/2	11/32	1/4	R68	5/16	9/16	1/8
20	22	23 1/2	11/32	1/4	R72	5/16	9/16	1/8
24	26 1/2	28	11/32	1/4	R76	5/16	9/16	1/8

DIMENSIONS are shown in inches, and conform to ASA Specification B16.5, and API 5-G3

RING JOINT flanges will be furnished in accordance with these details, unless otherwise specified by the purchaser. Lap joint stubs will also conform to these dimensions.

DEPTH of groove is added t flange thickness, except that on sizes marked (*), the groove will cut 1/32" into the minimum flange thickness.

CORNER RADIUS "r" is 1/32" for ring width 7/16" and smaller; 1/18" for ring widths 1/2" to 7/8" inclusive and 3/32" for ring widths 1" and larger.

FLAT-BOTTOMED, as shown in detail, will be furnished unless otherwise specified.

TOLERANCES:

- P ± .005" B ± 1/64" H ± 1/64"
- A ± .008" D ± 1/64" L ± 1/64"